

BEACH AREA MASTER PLAN

RECOMMENDATIONS FROM BEACH
DESIGN CHARRETTE OF 11/4/2009
PRESENTATION TO CITY COMMISSION
MAY 18, 2010

SHORT-TERM RECOMMENDATIONS ONGOING OPERATIONS, MAINTENANCE AND LANDSCAPING

- ENFORCEMENT OF CITY ORDINANCES AND POLICIES
 - IMPROVE POLICE AND SAFETY PATROLLING
 - ENFORCE LITTERING RULES
 - NO DOGS ON THE BEACH
 - ENFORCE KITE SURFING SAFETY RULES
 - ENFORCE JET-SKI AND BOAT SAFETY DISTANCES
 - A1A AUTO TRAFFIC ENFORCEMENT
 - PEDESTRIAN CROSSWALKS
 - ILLEGAL U-TURNS
 - PARKING METERS

SHORT-TERM (CONTINUED)

- MAINTENANCE AND LANDSCAPING
 - TRIM DUNE VEGETATION
 - KEEP SEA GRAPES AT WAIST LEVEL
 - ELIMINATE INVASIVE PLANTS
 - THIN OUT VEGETATION AT BEACH ENTRANCES
 - STRAIGHTEN AND REINFORCE SNOW FENCE
 - ESTABLISH REQUIRED AND CONSISTENT SIGNS PLAN
 - ALIGN AND RE-SPACE EXISTING BENCHES
 - REESTABLISH SCREENING OF UTILITIES EQUIPMENT AND NEWSPAPER DISPENSERS
 - EVALUATE NEED FOR REMOVAL OF REDUNDANT UTILITY POLES AND FIXTURES
 - EXTRA MAINTENANCE AT BUSIEST BEACH AREAS
 - INCLUDE RECYCLING CONTAINERS
 - ADD TRASH CONTAINERS OR INCREASE TRASH PICK UP
 - DUNE AREAS AT ATLANTIC AVE, ACROSS SANDOWAY & ANCHOR PARKS

SHORT-TERM (CONTINUED)

- OTHER SHORT-TERM ISSUES
 - OFFICIAL BEACH PARK DESIGNATION/RENAMING
 - PROVIDE MORE OPEN SPACE ON BEACH BY REDUCING RESERVED SPACE FOR RENTAL EQUIPMENT
 - REMOVE/RELOCATE SIDEWALK OBSTACLES
 - ESTABLISH SMOKING REGULATIONS/RESTRICTIONS
 - PUBLIC RELATIONS - PUBLISH BEACH HISTORY, RULES & REGULATIONS, AMENITIES IN VARIOUS NEWSLETTERS A FEW TIMES EACH YEAR

MID-TERM RECOMMENDATIONS

ANTICIPATED REPLACEMENT AND UPGRADES

- DEVELOP A FORMAL BEACH AREA MASTER PLAN
 - OVERALL DESIGN
 - INTERSECTION OF OCEAN AND ATLANTIC
 - STRUCTURES (EXISTING AND NEW)
 - SIDEWALK(S) LAYOUT AND MATERIALS
 - DEFINE FUNDING AND GRANTS OPPORTUNITIES
 - INVOLVE BUSINESS COMMUNITY IN PUBLIC/PRIVATE PARTNERSHIP
- BEACH AREA STRUCTURES
 - ADOPT DESIGN BASED ON HISTORIC PAVILION
 - REPLACE DETERIORATED PAVILION (OCEAN AND ATLANTIC)
 - REPLACE DETERIORATED GAZEBOS (LAING, NASSAU)

MID-TERM (CONTINUED)

- REPLACE AGING STREET FURNITURE
 - BENCHES
 - TRASH CANS
 - SHOWERS
- REPLACE/PROVIDE WOODEN BEACH ENTRANCE WALKWAYS
- REPLACE PARKING METERS
 - ELIMINATE INDIVIDUAL METERS
 - INSTALL CENTRALIZED METER STATIONS
 - USING NUMBERED PARKING SPACES OR DASHBOARD RECEIPTS
 - PROVIDE VARIETY OF PAYING OPTIONS

LONG-TERM RECOMMENDATIONS

FUTURE IMPROVEMENTS AND NEW FEATURES

- NEW STRUCTURES
 - STATEMENT FEATURE AT OCEAN AND ATLANTIC INTERSECTION
 - PERGOLAS AT NORTH AND SOUTH POINTS OF BEACH
 - TRASH/RECYCLE SMALL ENCLOSURES
 - FOR TRASH CANS ON BEACH
 - WEST FACING SIDE TO SERVE AS AREA FOR SAFETY SIGNS
- SIDEWALK REPLACEMENT
 - WIDEN OR DUAL SIDEWALK DESIGN WHERE POSSIBLE
 - LAYOUT AS CURVING DESIGN
 - LANDSCAPE IN GREEN POCKETS (BETWEEN SIDEWALK AND STREET)
 - PATTERNED MATERIAL FOR SIDEWALK SURFACE
 - CREATE MORE OCEAN VISTAS

LONG-TERM (CONTINUED)

- OTHER FEATURES
 - PEDESTRIAN CROSSWALKS - MORE AND BETTER DEFINED
 - ELEVATED VIEWING AND OPEN SITTING AREAS
 - ENVIRONMENTAL LIGHTING
 - STREET LIGHTS
 - LOW-LEVEL SIDEWALK LIGHTS
 - BURY POWER LINES ALONG OCEAN BLVD.
 - HISTORICAL AND NATURE MARKERS
 - SHADE TREES EAST SIDE OF DUNES

This map of the eastern portion of Delray Beach is keyed to the development opportunities illustrated in the Currie renderings that appear on the following pages.

A-1: Plan of "T" intersection at Atlantic Ave. & Ocean Blvd.

A-2: Ground level view Looking east from Atlantic Ave.

A-3: New pavilion on Ocean Blvd.

B-1: Plan of prototype pedestrian crossing and pergola at each end of public beach.

B-2: View of the pergola, new plantings and pathways.

B-3: Ground level view of pergola to be placed at each end of the public beach.

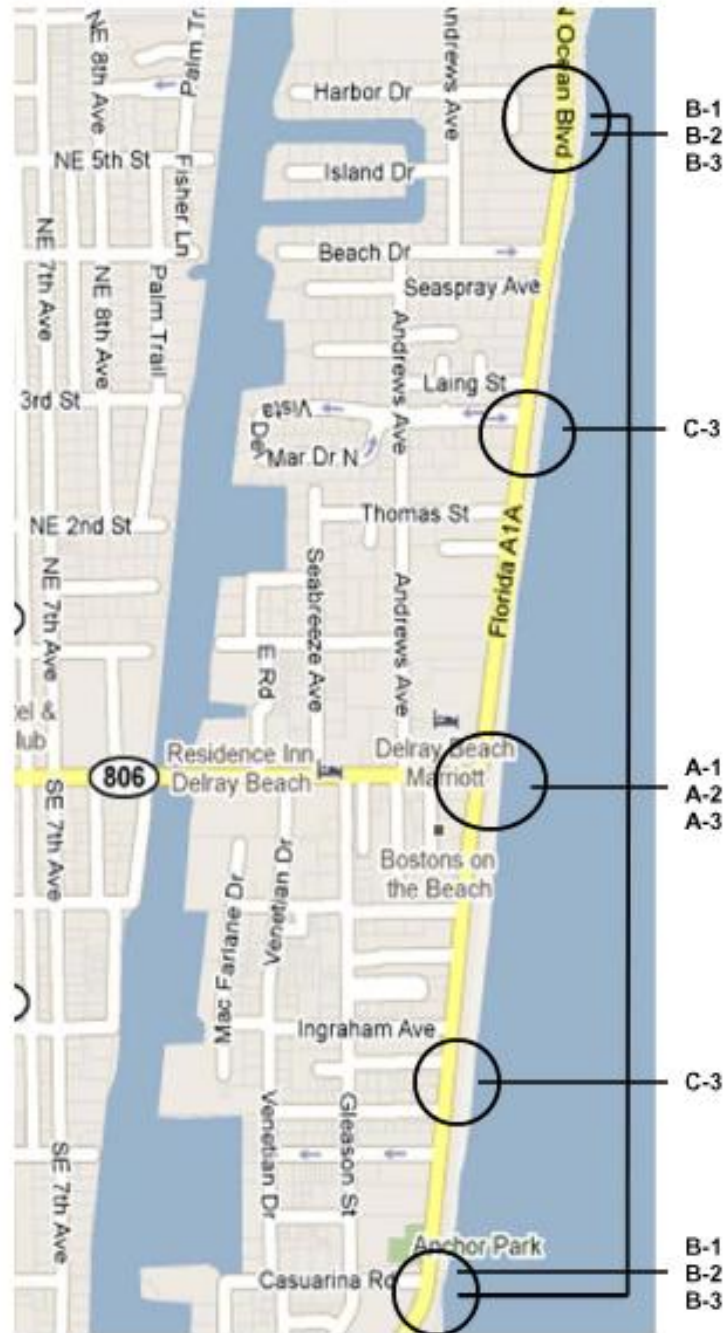

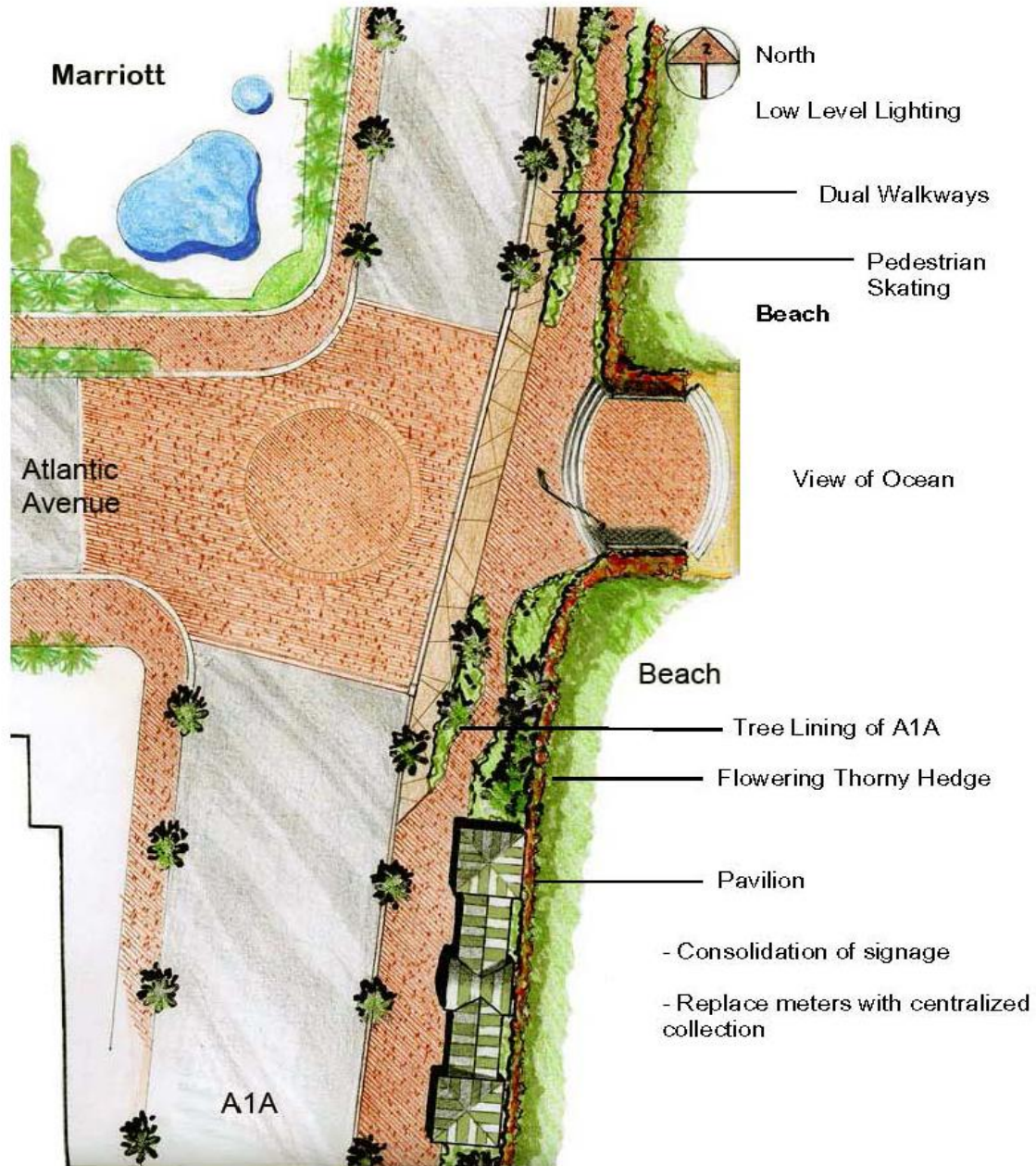

A-1: Plan of "T" intersection at Atlantic Avenue and Ocean Boulevard/SR A1A.



A-2: Ground level view at the intersection of Atlantic Avenue and Ocean Boulevard/SR A1A showing the vegetation cleared away to produce a view to the ocean.



A-2: Alternate option for ground level view at the intersection of Atlantic Avenue and Ocean Boulevard/SR AIA.



A-3: The new pavilion on Ocean Boulevard/SR A1A.

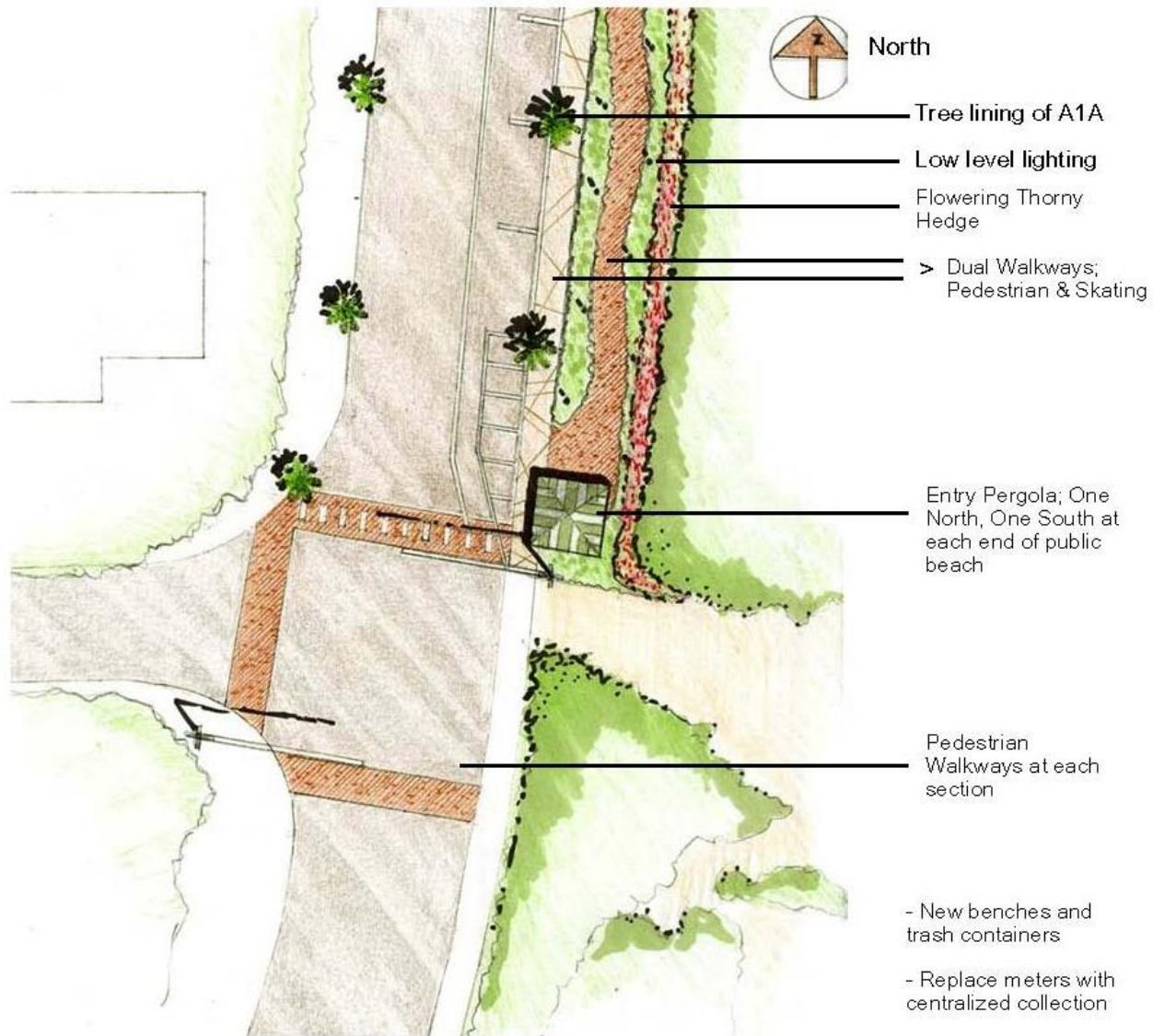

B-1: Plan of the pedestrian crossing at Casuarina Road crossing with a prototype pergola that could be placed at each end of the public beach.



B-3: Ground level view of a prototype pergola to be placed at each end of the public beach.

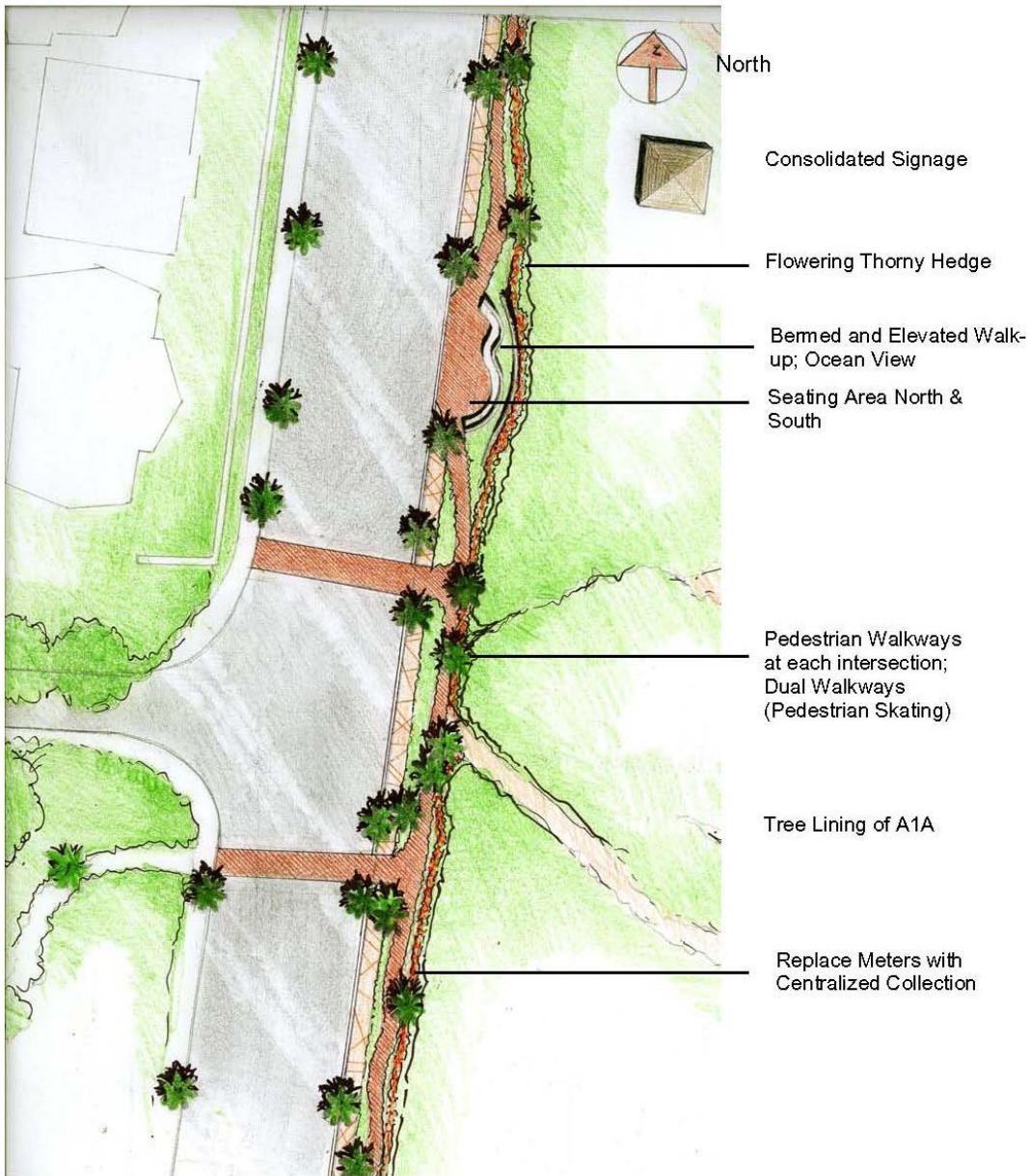

B-4: Pathway, social areas with benches, and pedestrian crosswalks with textured pavers can satisfy both functional and aesthetic requirements for Delray Beach.



B-2: View of open seating, new plantings and pathways.



C-1: Beach signage and refuge containers.



C-2: Beach Shower.



C-3: Small Gazebo.